

3RD FLOOR

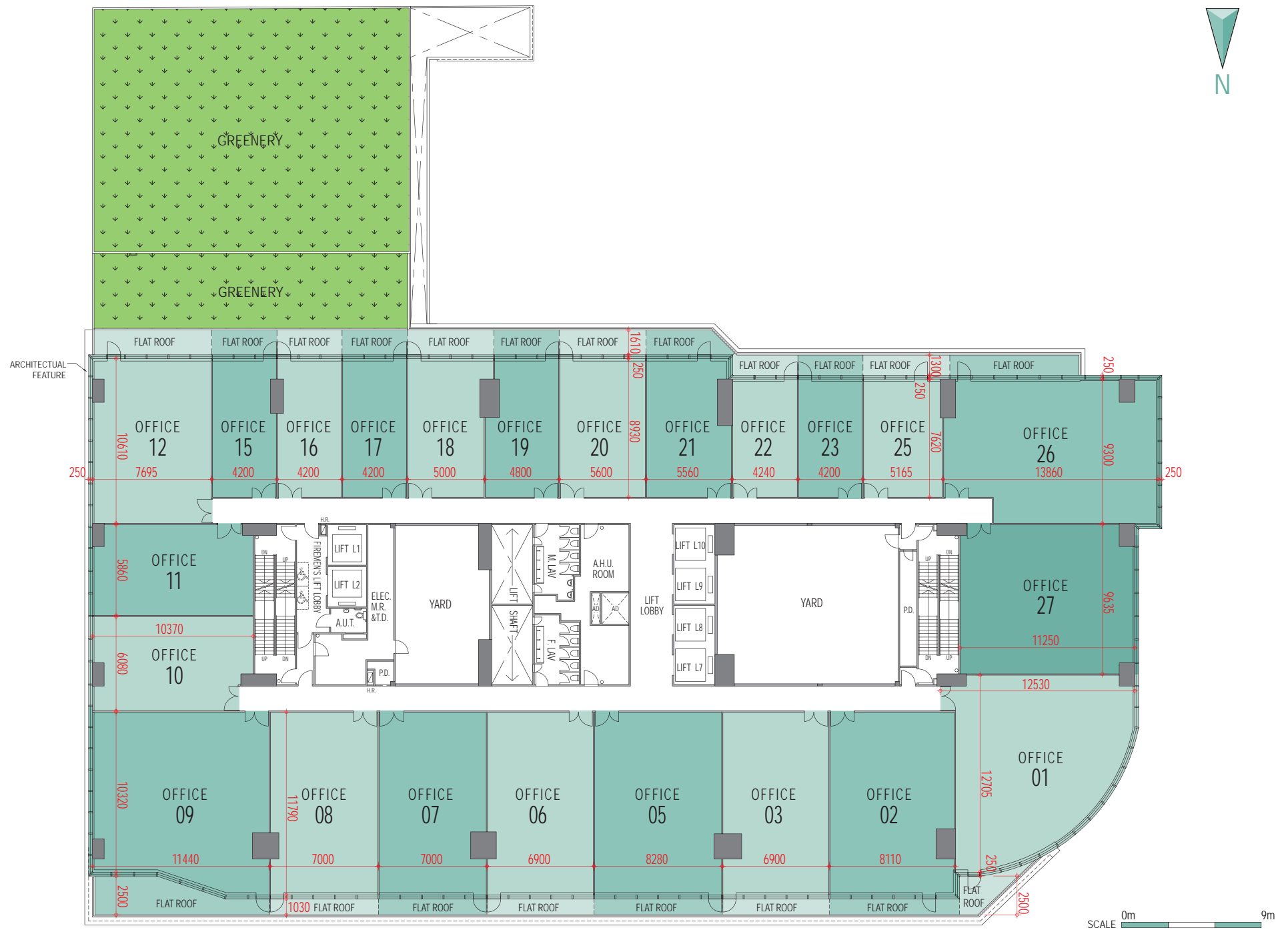

AREA SCHEDULE

AREA (sq.ft.)	OFFICE	01	02	03	05	06	07	08	09	10	11	12	15
Gross Floor Area		2,117	1,588	1,352	1,644	1,367	1,375	1,388	2,137	1,065	1,047	1,420	634
Saleable Area		1,400	1,050	894	1,087	904	909	918	1,413	704	692	939	419
Flat Roof		77	93	76	92	76	78	78	223	-	-	132	73

AREA (sq.ft.)	OFFICE	16	17	18	19	20	21	22	23	25	26	27
Gross Floor Area		634	634	782	696	844	817	572	543	684	2,126	1,839
Saleable Area		419	419	517	460	558	540	378	359	452	1,406	1,216
Flat Roof		73	73	97	73	97	87	59	59	78	116	-

備註 Notes

不設4樓、13樓、14樓及24樓 Omitted 4/F, 13/F, 14/F and 24/F

賣方保留權利不時改動發展項目的建築圖則及其他圖則。發展項目的設計以政府相關部門最後批准的圖則為準。The vendor reserves the right to make alterations to the building plans and other plans relating to the Development from time to time, and the design of the Development shall be subject to the final plans approved by the relevant Government authorities. 因較高樓層的結構牆的厚度遞減，較高樓層的單位的內部面積，一般比較低樓層的單位的內部面積稍大。The internal areas of units on upper floors will generally be slightly larger than lower floors due to the reducing thickness of structural walls on upper levels. 樓面平面圖之尺規所列數字為以毫米標示之建築結構尺寸。The dimensions in the floor plans are all structural dimensions in millimetre.