

17TH FLOOR

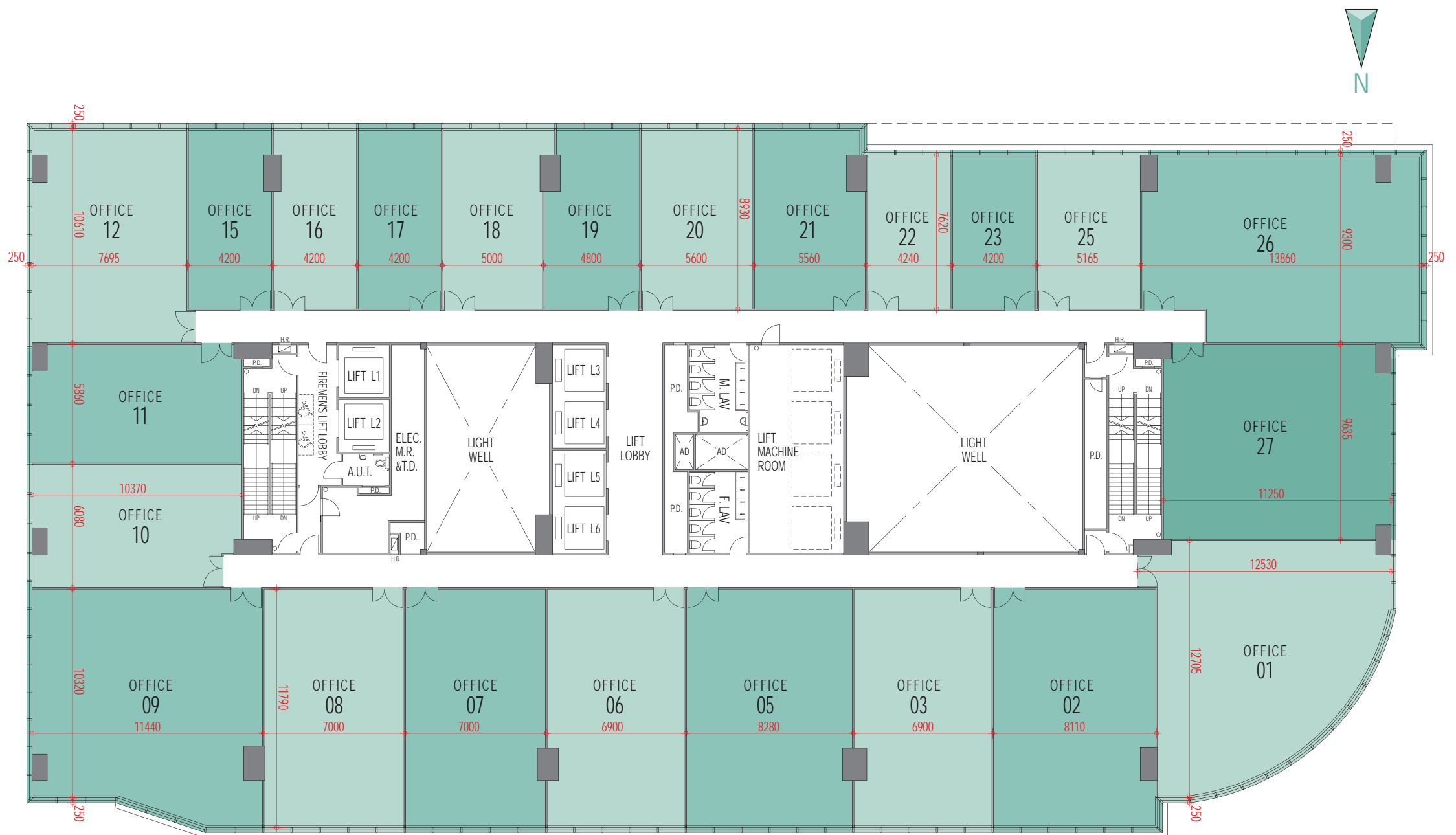

SCALE 0m 9m

AREA SCHEDULE

AREA (sq.ft.)	OFFICE	01	02	03	05	06	07	08	09	10	11	12	15
Gross Floor Area		2,108	1,597	1,360	1,636	1,360	1,384	1,393	2,131	1,065	1,048	1,429	632
Saleable Area		1,394	1,056	899	1,082	899	915	921	1,409	704	693	945	418

AREA (sq.ft.)	OFFICE	16	17	18	19	20	21	22	23	25	26	27
Gross Floor Area		634	634	779	699	844	826	563	543	682	2,125	1,842
Saleable Area		419	419	515	462	558	546	372	359	451	1,405	1,218

備註 Notes

不設4樓、13樓、14樓及24樓 Omitted 4/F, 13/F, 14/F and 24/F

賣方保留權利不時改動發展項目的建築圖則及其他圖則。發展項目的設計以政府相關部門最後批准的圖則為準。The vendor reserves the right to make alterations to the building plans and other plans relating to the Development from time to time, and the design of the Development shall be subject to the final plans approved by the relevant Government authorities. 因較高樓層的結構牆的厚度遞減，較高樓層的單位的內部面積，一般比較低樓層的單位的內部面積稍大。The internal areas of units on upper floors will generally be slightly larger than lower floors due to the reducing thickness of structural walls on upper levels. 樓面平面圖之尺規所列數字為以毫米標示之建築結構尺寸。The dimensions in the floor plans are all structural dimensions in millimetre.